

timfog

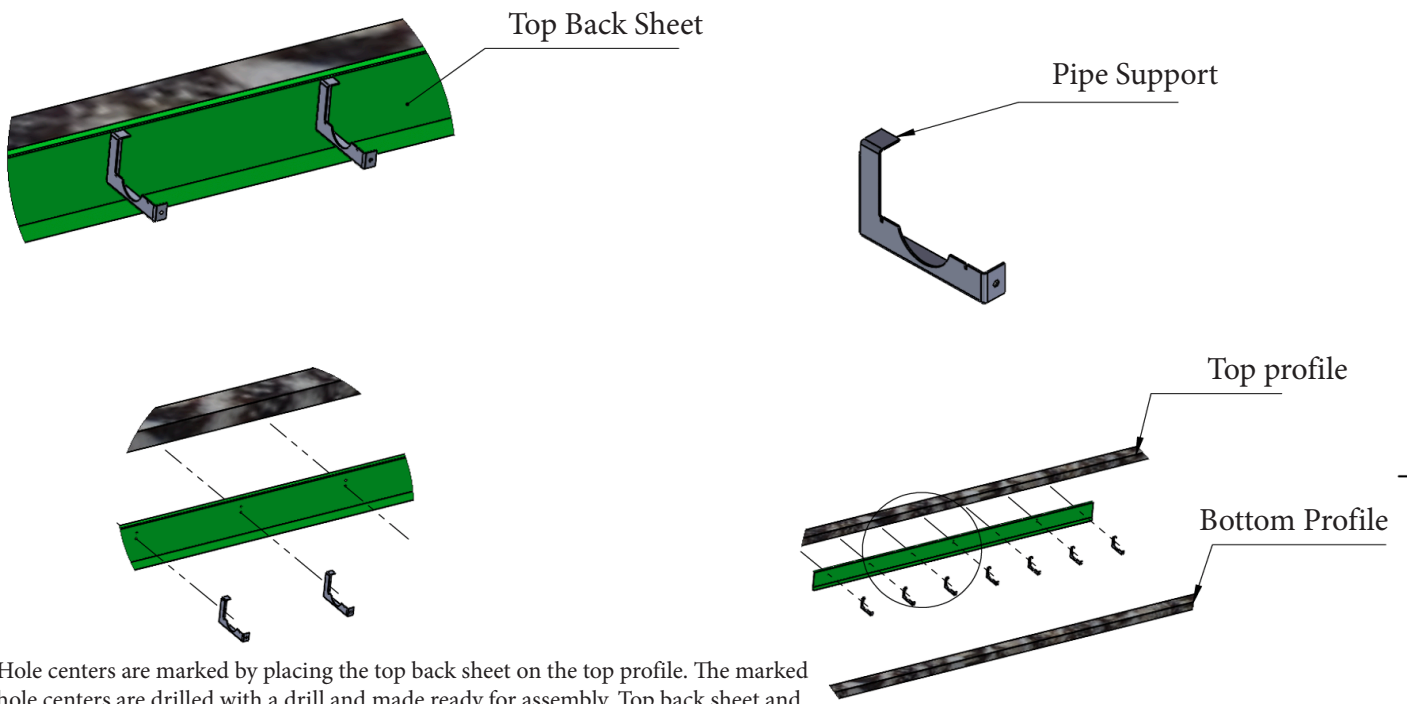

METAL KASALI FAN PAD SİSTEMİ

MONTAJ TALİMATNAMESİ

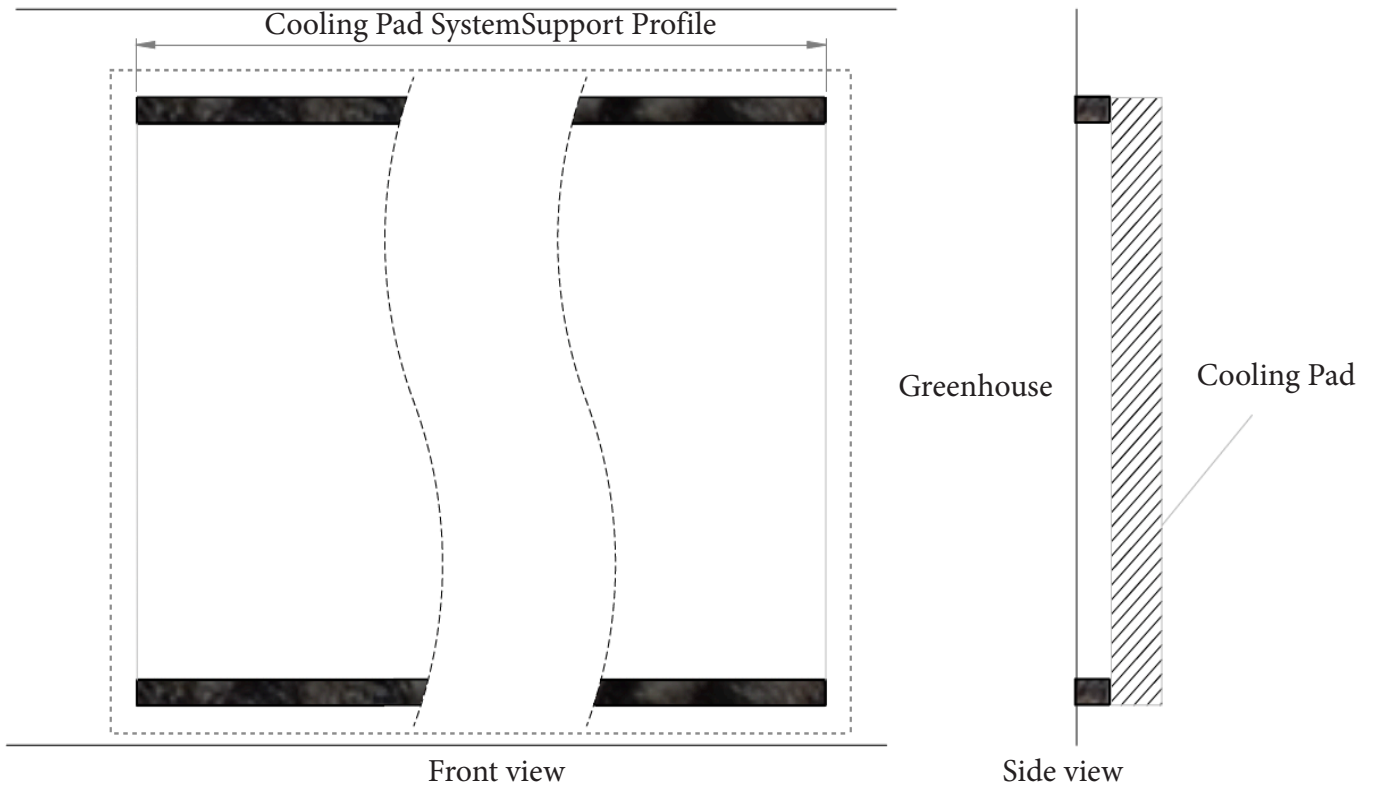

Hole centers are marked by placing the top back sheet on the top profile. The marked hole centers are drilled with a drill and made ready for assembly. Top back sheet and pipe support part are fixed to the top profile with 2 pcs Ø5,5x32mm trapez screws.

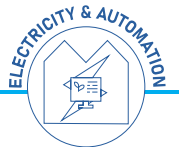
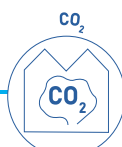
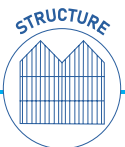

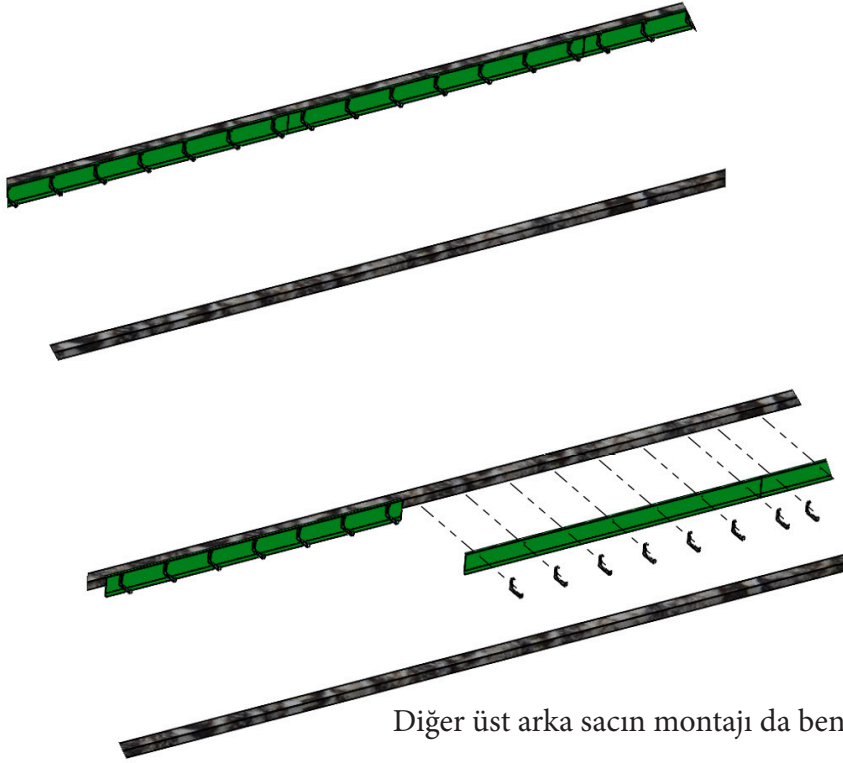

Diğer üst arka sacın montajı da benzer şekilde tamamlanır.

Üst arka sacdan 335mm mesafe bırakılarak ilk konsolun yeri belirlenir. konsoldaki delikler kullanılarak profil üzerine delik merkezleri işaretlenir ve montaj delikleri açılır. 4 pcs Ø5,5x32mm trapez screws ile konsol profile montaj edilir.

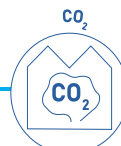
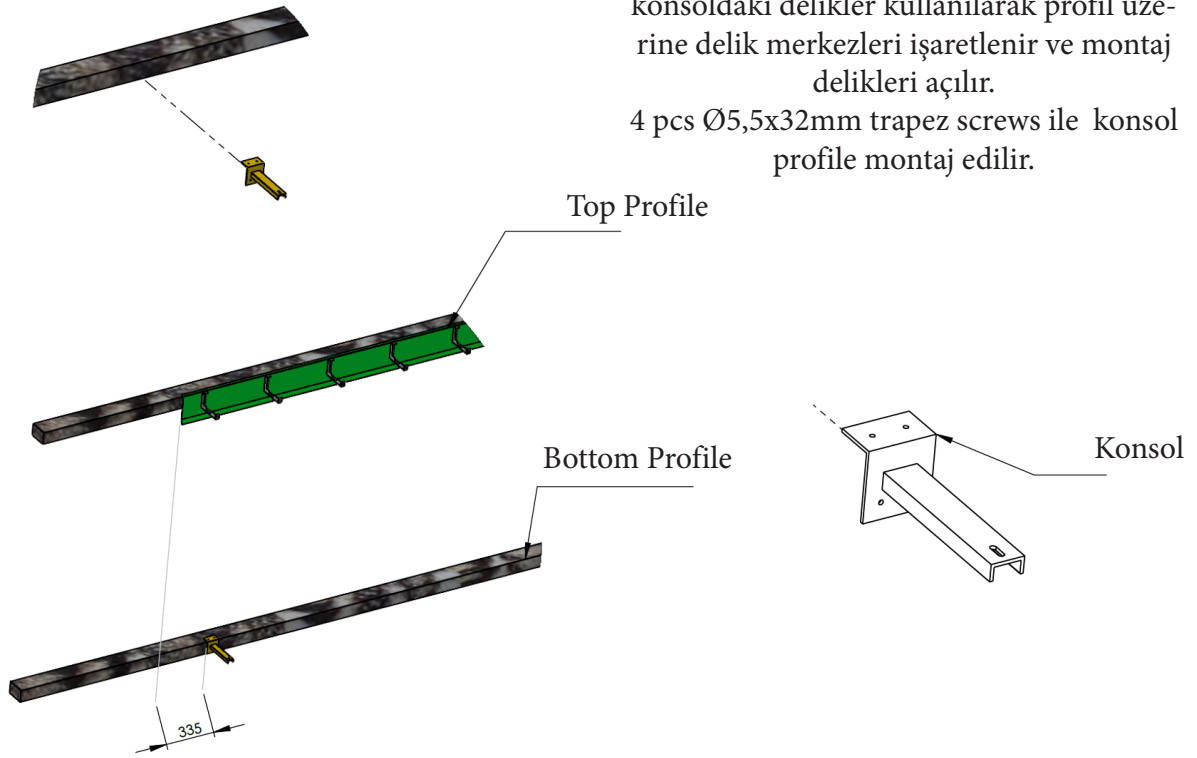

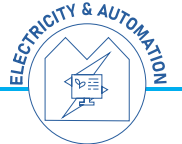
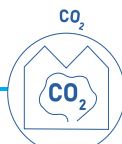
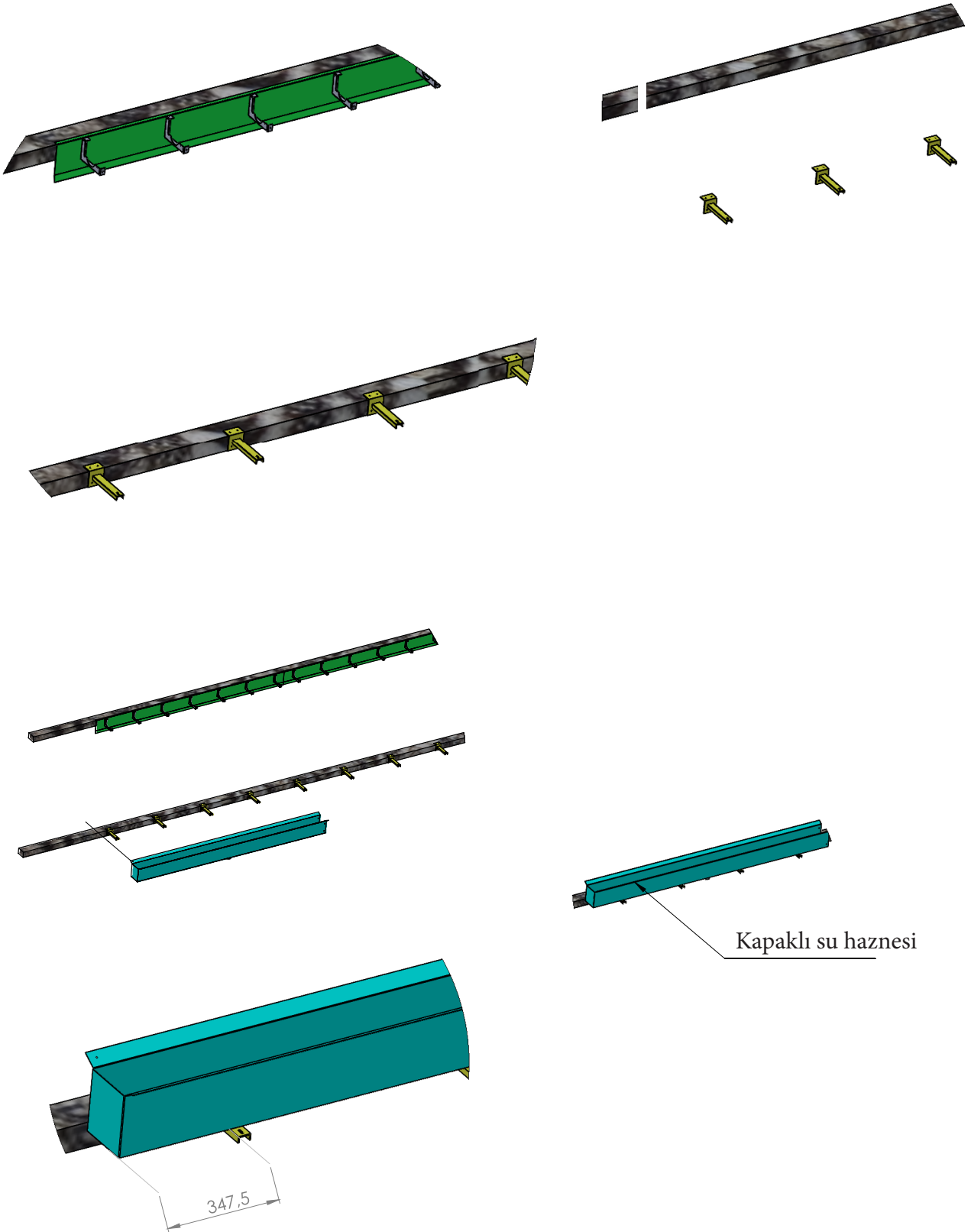

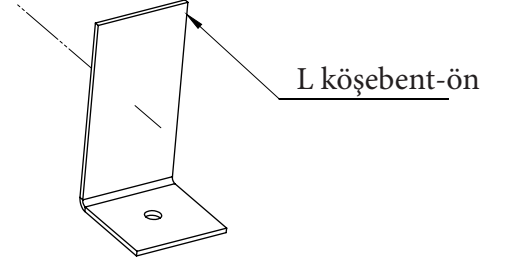
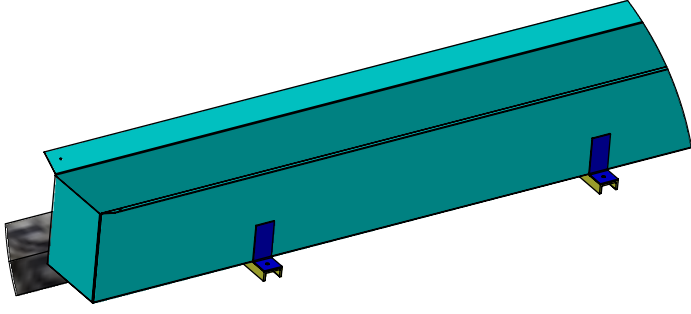

Su haznesi L köşebent ve M6x20 galvaniz civata+so-
mun ile sıkıştırılarak konsola sabitlenir.

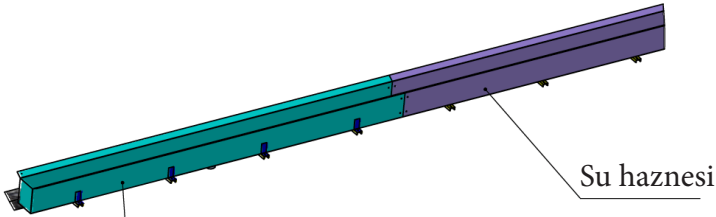
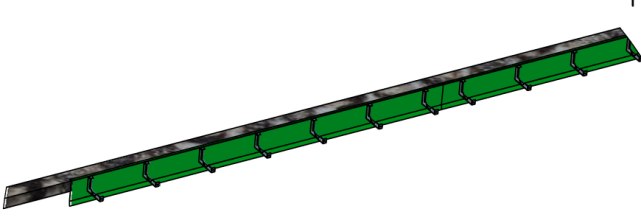
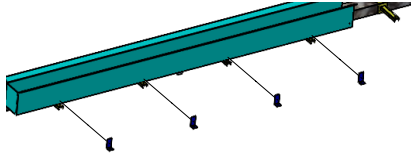

Kapaklı su haznesi

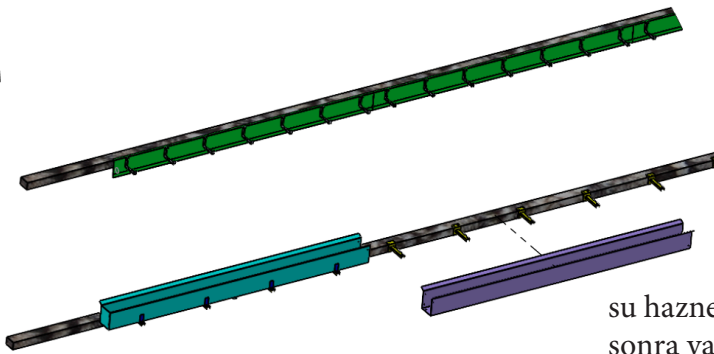

su haznesi,kapaklı su haznesinin montajından
sonra yanına konulur.

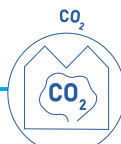

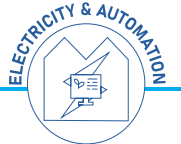
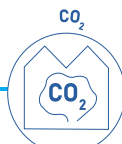
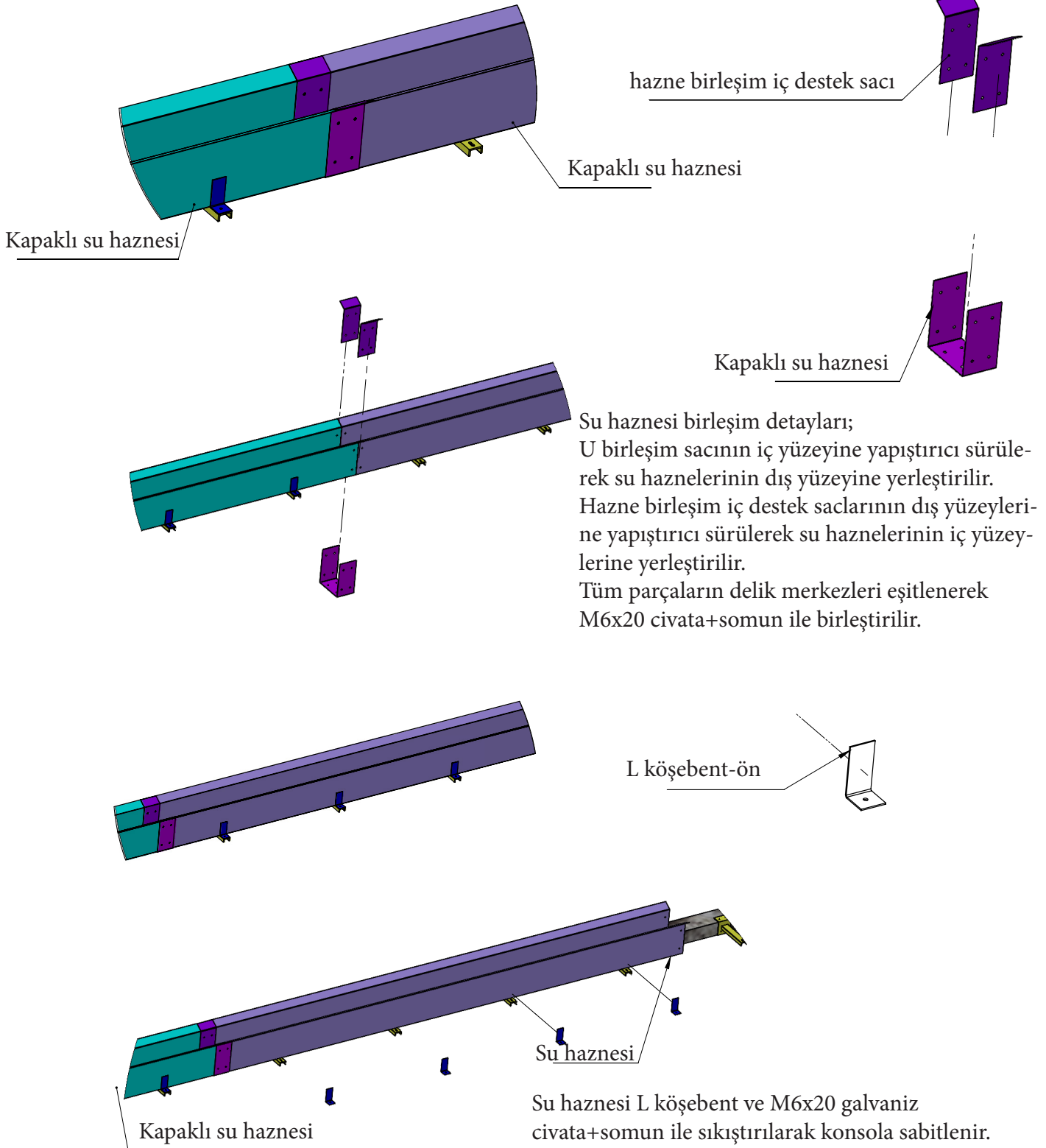

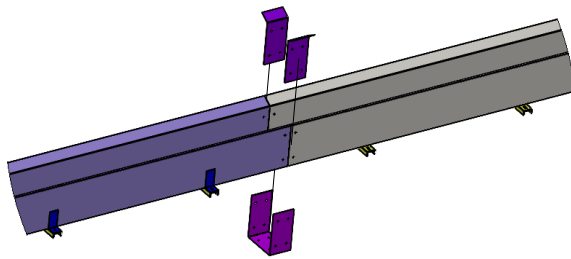
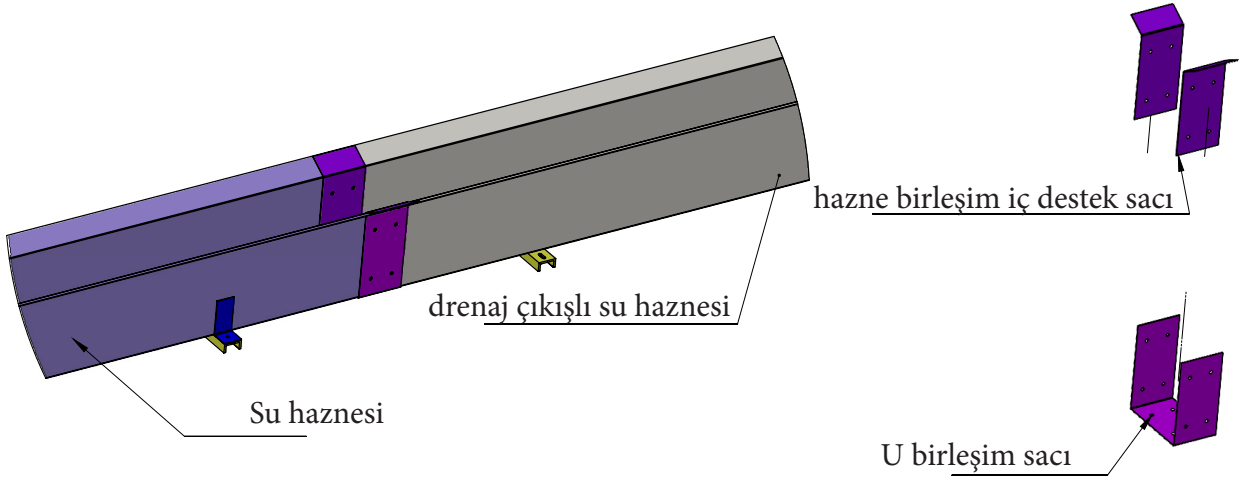
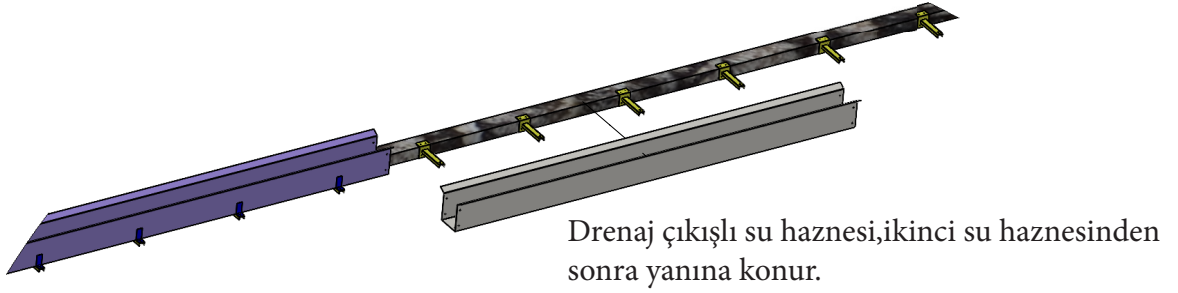
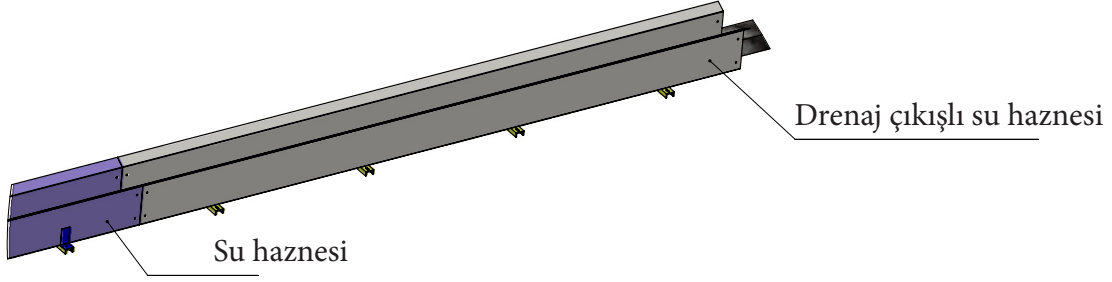

Drenaj çıkışlı su haznesi birleşim detayları; U birleşim sacının iç yüzeyine yapıştırıcı sürülerek su haznelerinin dış yüzeyine yerleştirilir.
Hazne birleşim iç destek saclarının dış yüzeylerine yapıştırıcı sürülerek su haznelerinin iç yüzeylerine yerleştirilir.
Tüm parçaların delik merkezleri eşitlenerek M6x20 civata+somun ile birleştirilir.

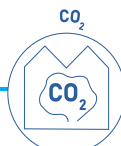

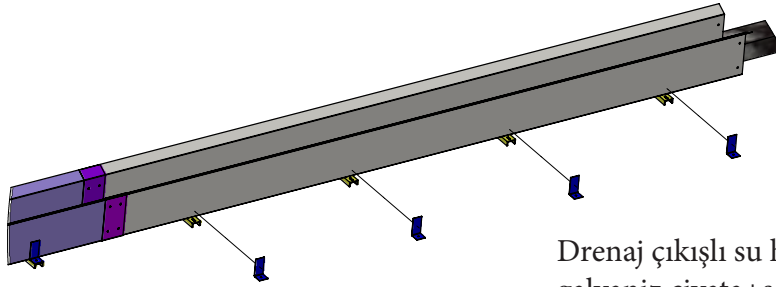
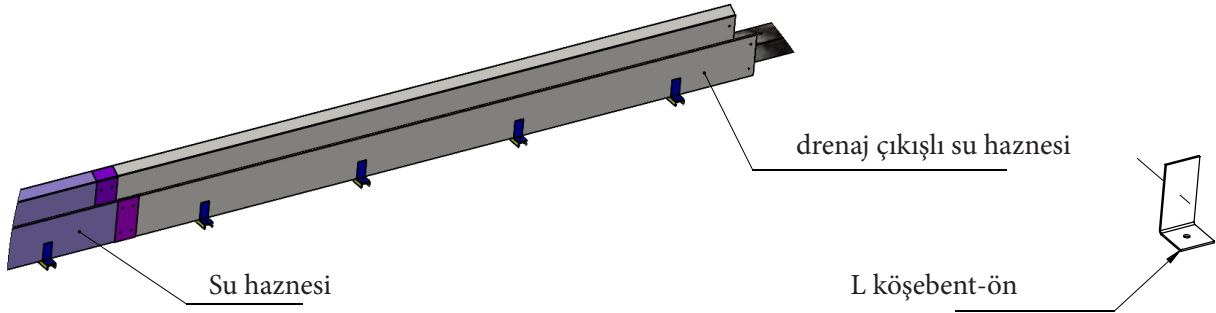

Drenaj çıkışlı su haznesi L köşebent ve M6x20 galvaniz civata+somun ile sıkıştırılarak konsola sabitlenir.

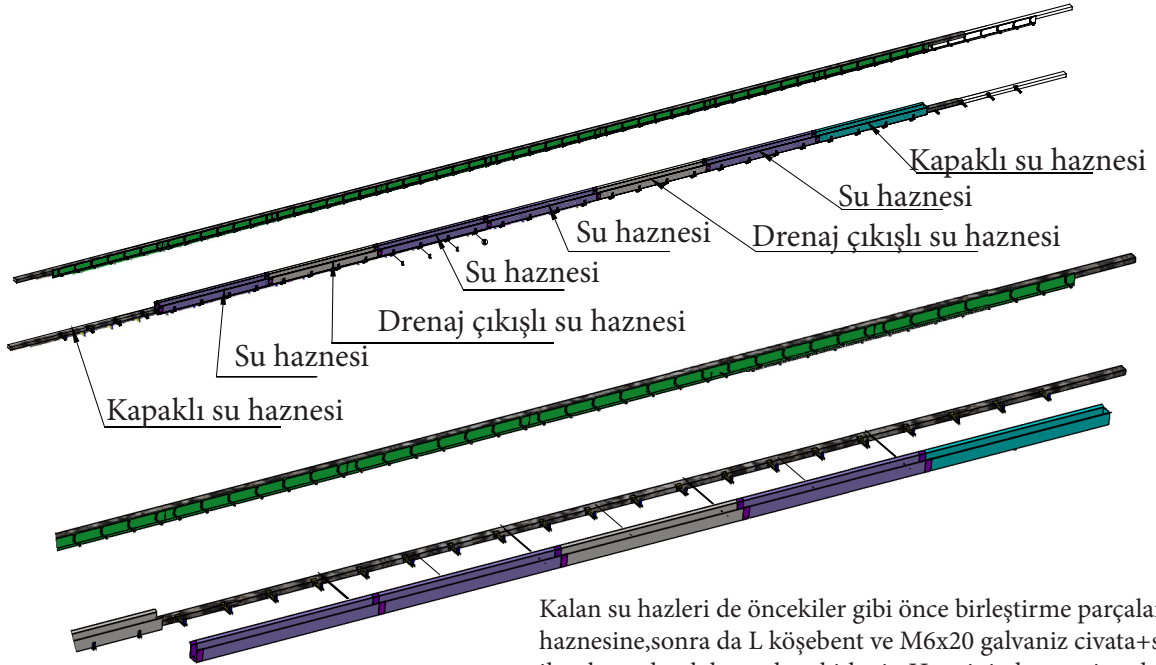

Kalan su hazneleri de öncekiler gibi önce birleştirme parçalarıyla su haznesine, sonra da L köşebent ve M6x20 galvaniz civata+somun ile sıkıştırılarak konsola sabitlenir. Hangi tip haznenin takılacağı yukarıda belirtilmiştir. En baş ve en sondaki parçalar yukarıdaki resimde verilmiştir. Fan pad in uzunluğuna göre ortadaki su haznesinin adedi değişecektir.

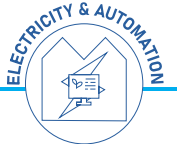
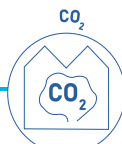

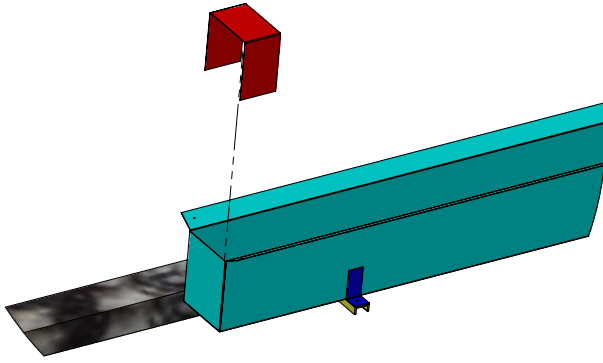
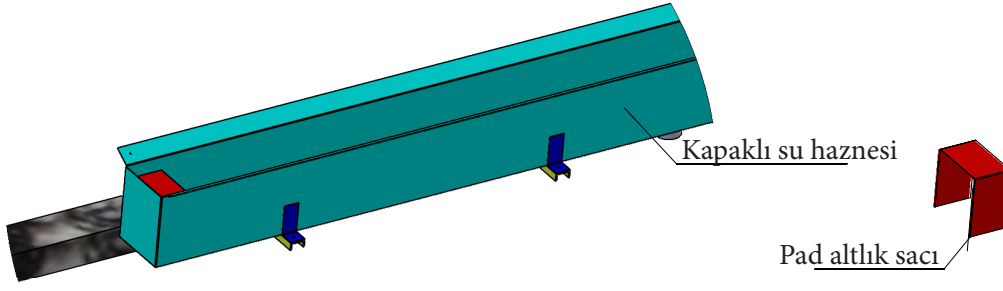

Selülozik fan padlerin altında taşıma görevi görecek olan altlık sacı konulur.

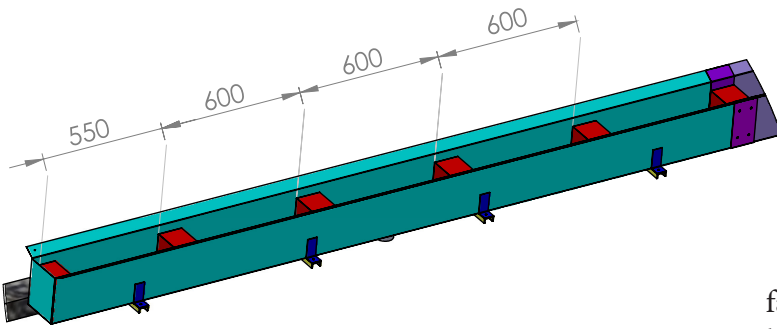

fan pad altlıkları verilen ölçülerde kapaklı su haznesinin dibine konulur

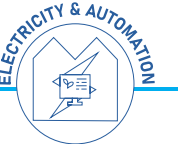
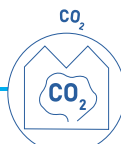
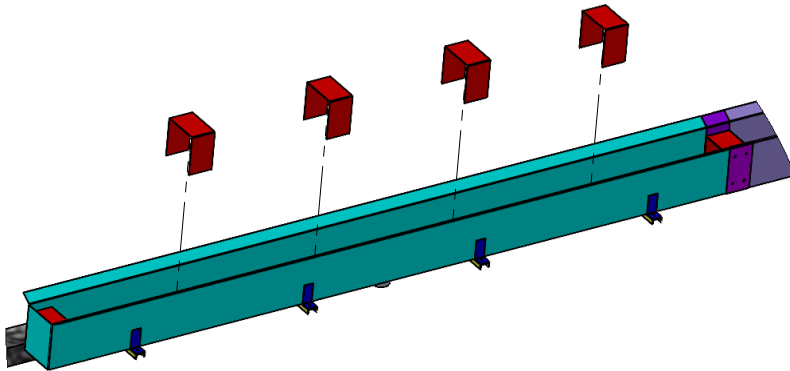

Selülozik fan pad(600x1500x150),
altlık sacının üzerine yerleştirilir.

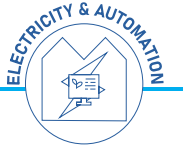
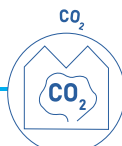
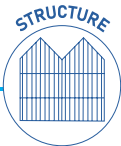
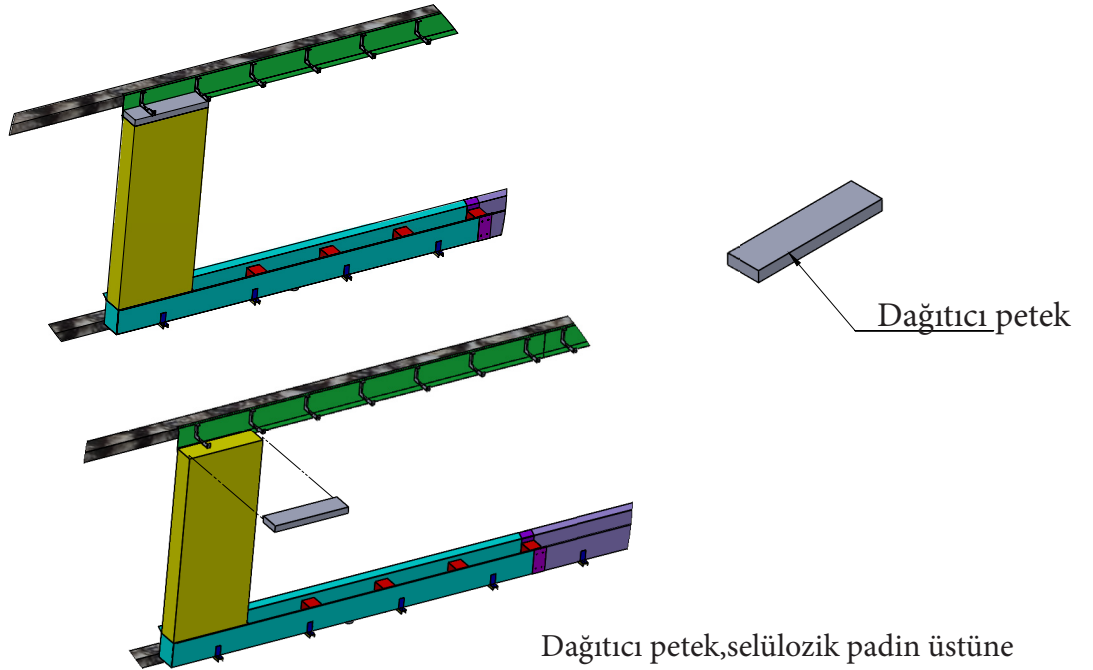
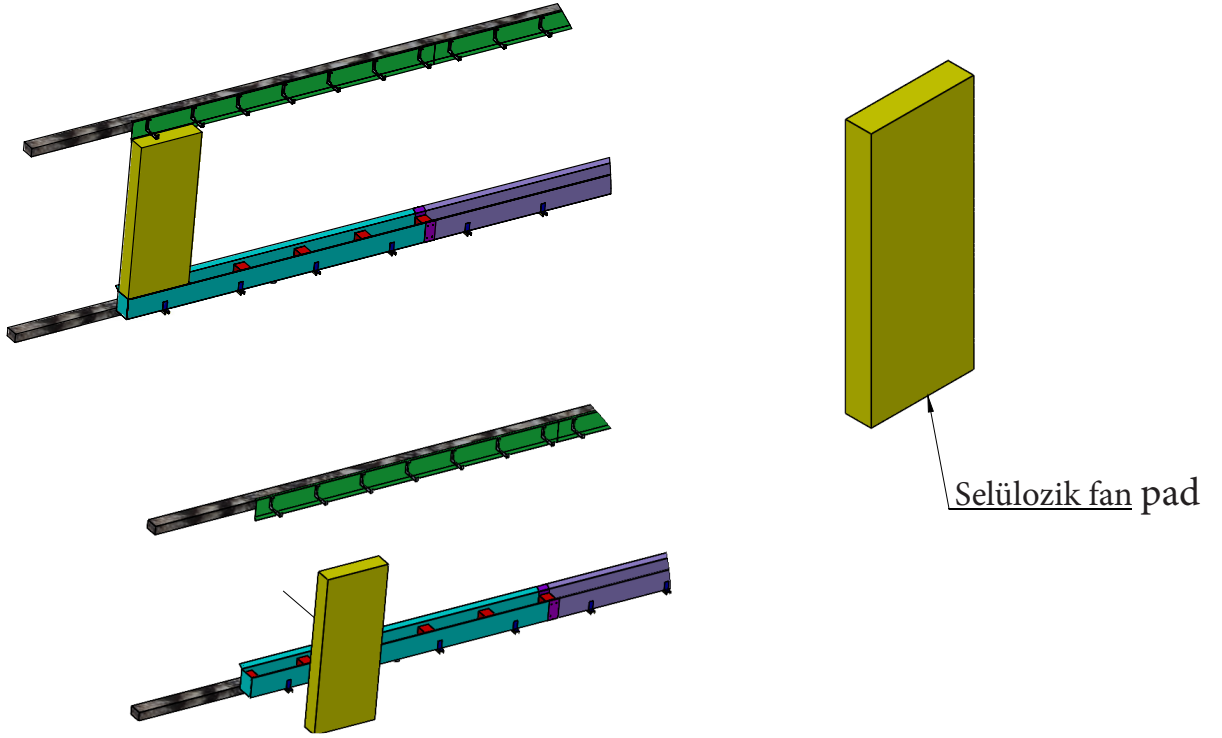

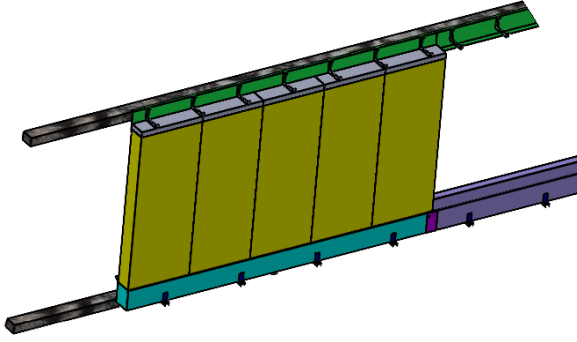

Kalan fan padler yan yana olacak şekilde taşıyıcı altılık saclarının üstüne konulur.

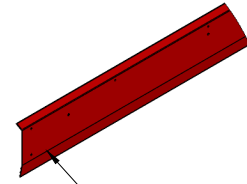
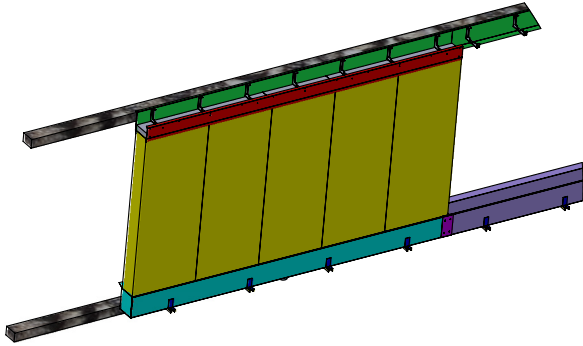
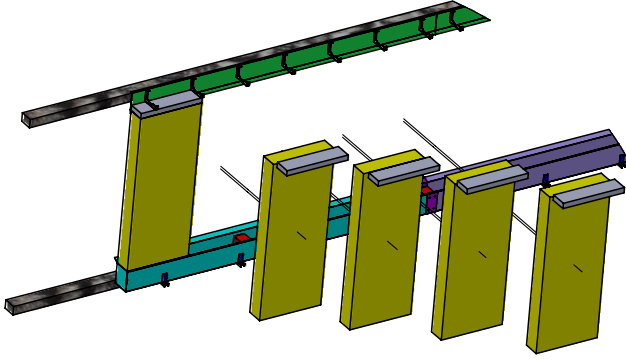

Üst ön sac

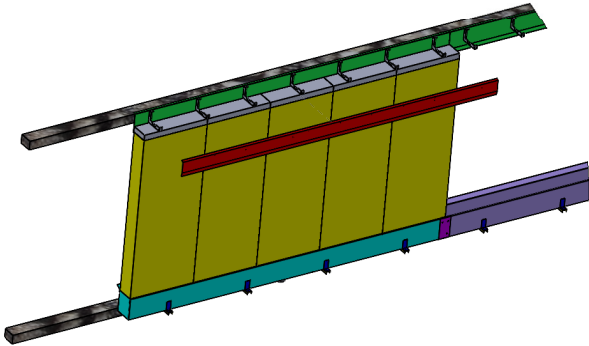
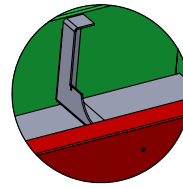

Üst ön sacın üstündeki Ø4,2mm deliklerden boru supportuna M4 altıgen perçin ile bağlantı sağlanır.

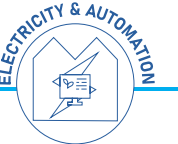
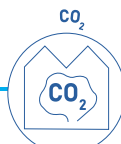

kapaklı su haznesindeki gibi geri kalan su haznelerine de sırasıyla altlık sacı, fan pad, dağıtıcı petek ve üst ön sac sırayla takılır.

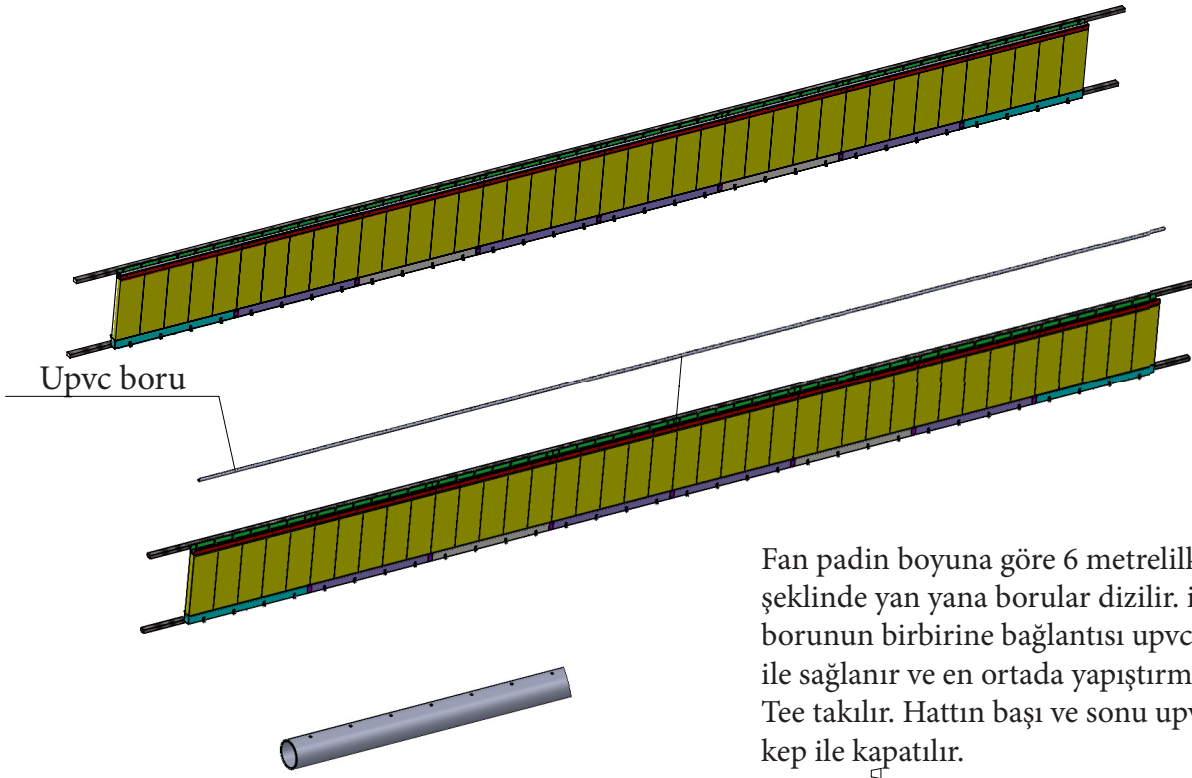
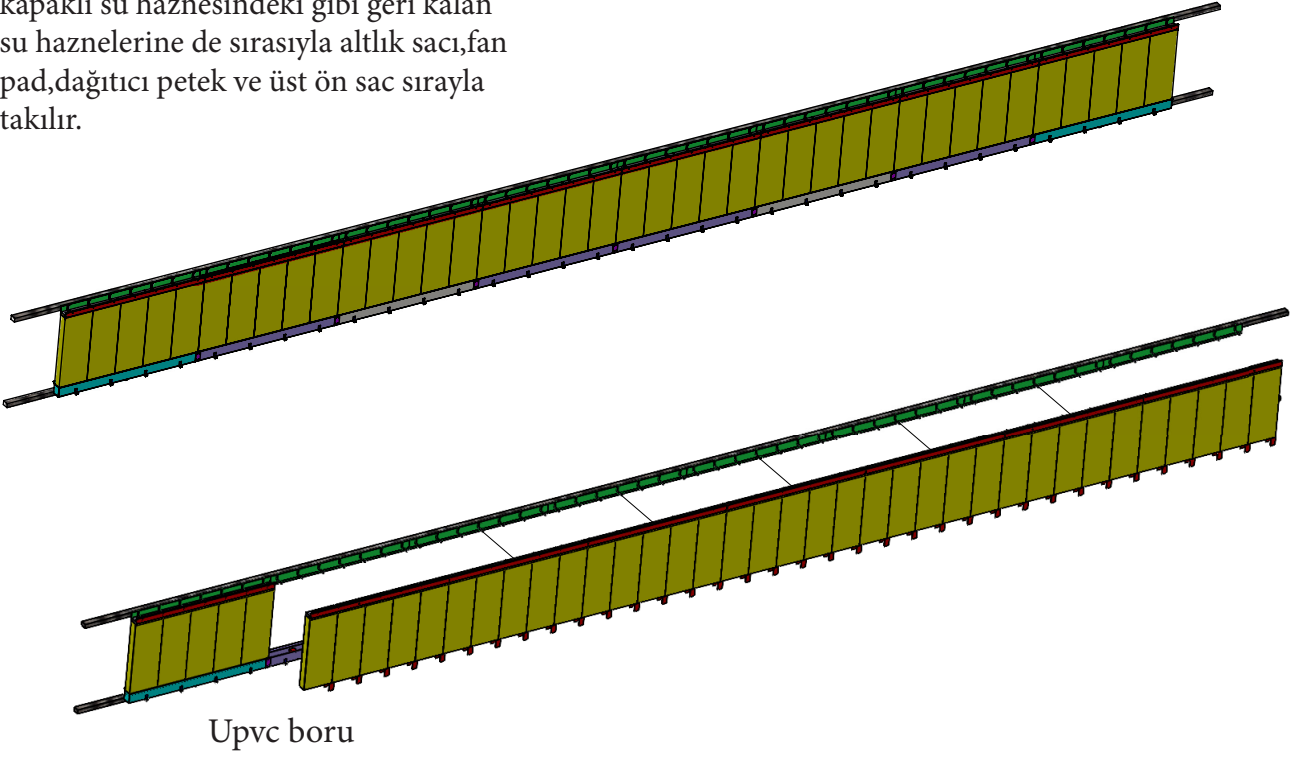

Fan padin boyuna göre 6 metrelik borular şeklinde yan yana borular dizilir. İki borunun birbirine bağlantısı upvc manşon ile sağlanır ve en ortada yapıştırma muflu Tee takılır. Hattın başı ve sonu upvc kep ile kapatılır.

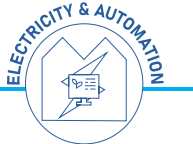
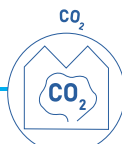
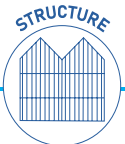

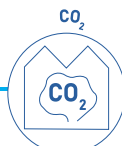
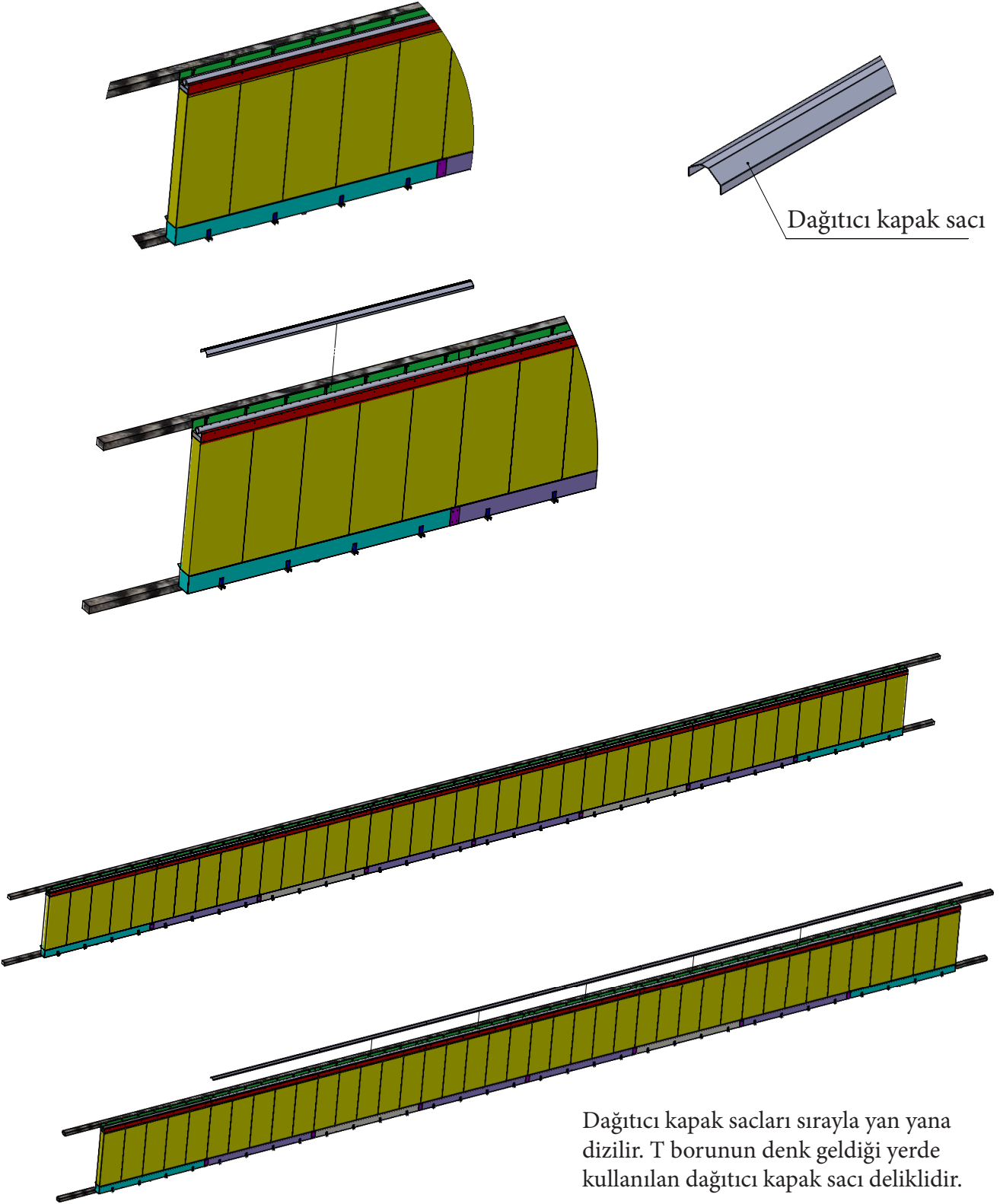

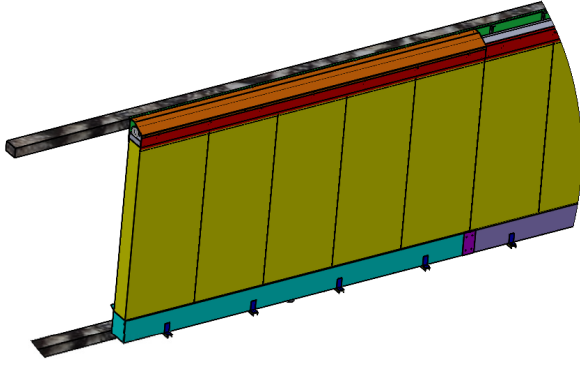

Kapak sacı takılır. Üst ön sacda karşılık gelen deliklerden akıllı vida ile montajı sağlanır.

Üst kapak sacı

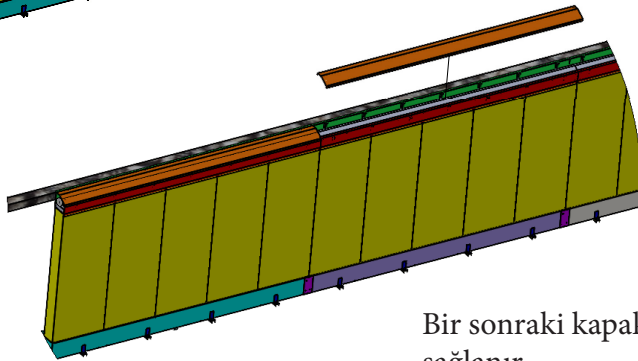
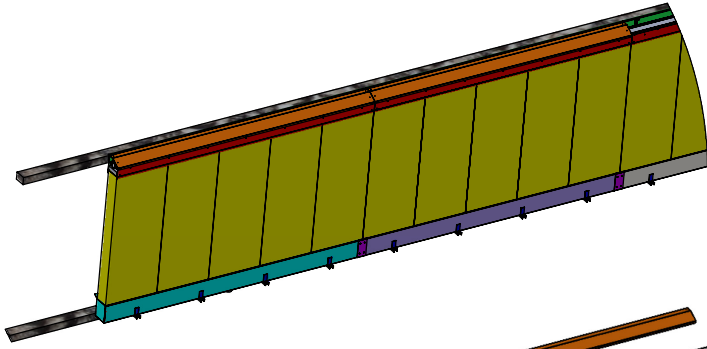
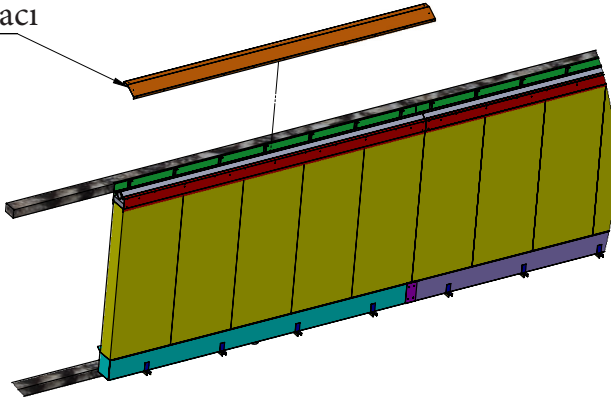

Bir sonraki kapak sacı takılır ve aynı şekilde montajı sağlanır

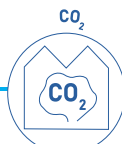
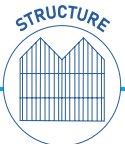

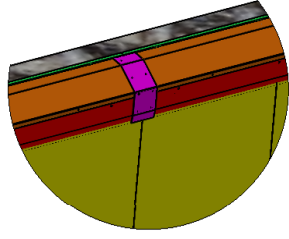

Üst kapak birleştirme sacı

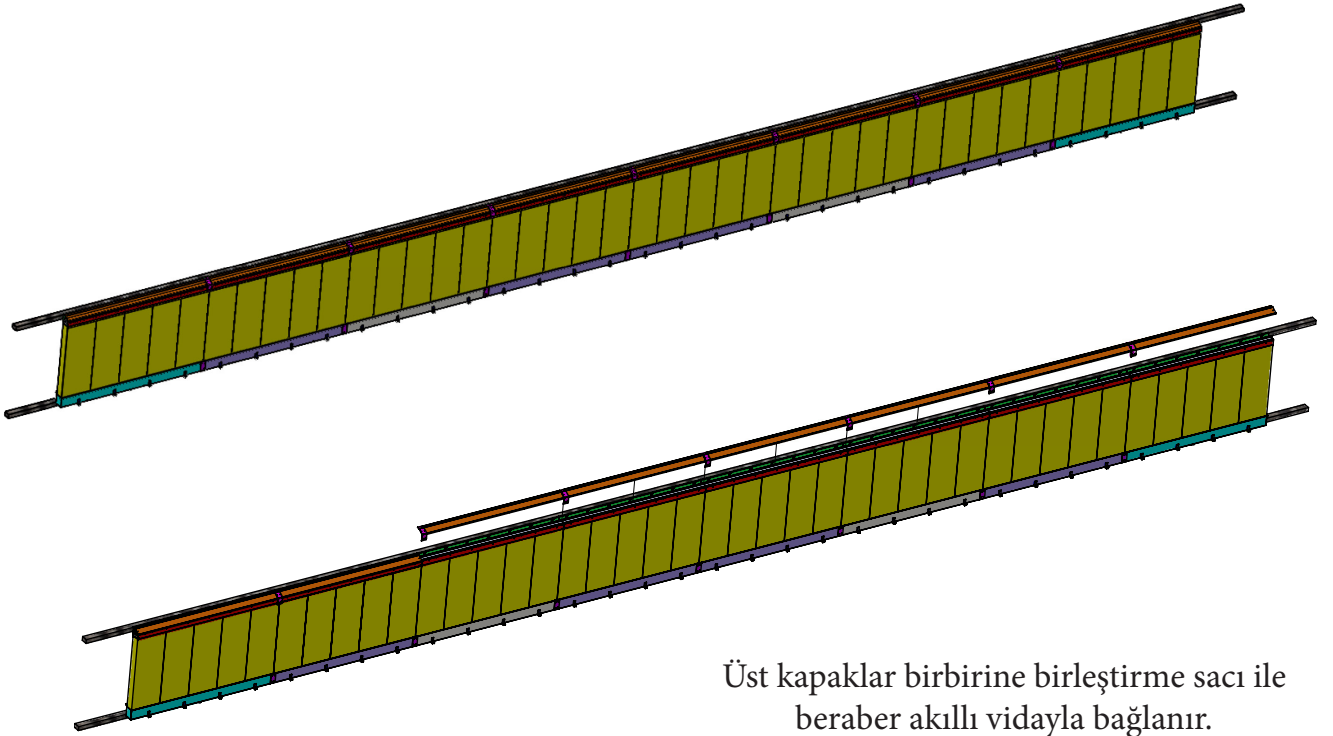
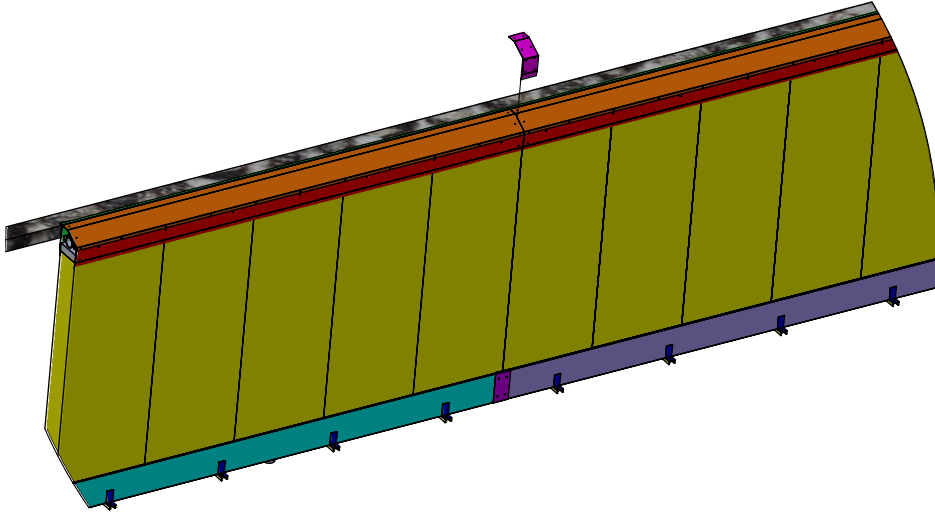
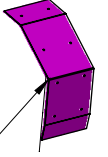

Üst kapaklar birbirine birleştirme sacı ile beraber akıllı vidayla bağlanır.

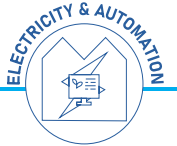
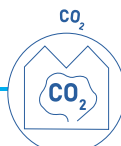

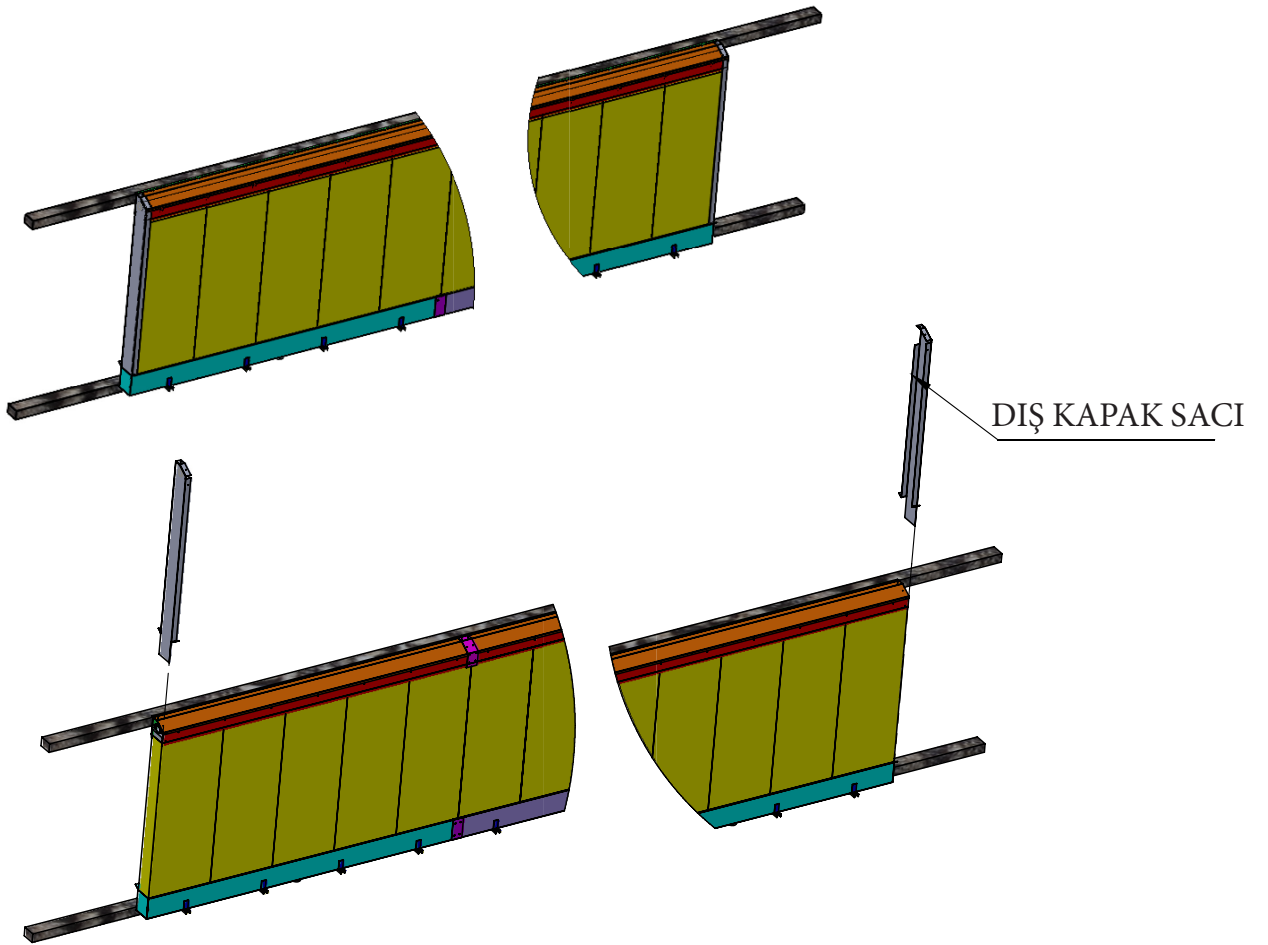

Dış kapak sacları en köşedeki su haznelerinin iç kısmına yerleştirilir ve haznenin bükümünde olan delikten ve üstteki saclarda karşılık gelen deliklerden akıllı vida ile montaj edilir.

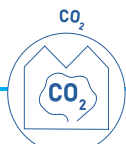
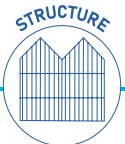

**Çerkeşli Osb Mah. İmes 7.Cadde
No:3 Dilovası/Kocaeli**

+90 262 244 44 94